

# SVENSK STANDARD

## SS-EN 16276:2013



Fastställt/Approved: 2013-01-28

Publicerad/Published: 2013-01-30

Utgåva/Edition: 1

Språk/Language: engelska/English

ICS: 12.010; 12.020; 93.080.40

---

### Utrymningsbelysning i vägtrafiktunnlar

### Evacuation Lighting in Road Tunnels

This preview is downloaded from [www.sis.se](http://www.sis.se). Buy the entire standard via <https://www.sis.se/std-88903>

# Standarder får världen att fungera

*SIS (Swedish Standards Institute) är en fristående ideell förening med medlemmar från både privat och offentlig sektor. Vi är en del av det europeiska och globala nätverk som utarbetar internationella standarder. Standarder är dokumenterad kunskap utvecklad av framstående aktörer inom industri, näringsliv och samhälle och befrämjar handel över gränser, bidrar till att processer och produkter blir säkrare samt effektiviserar din verksamhet.*

## Delta och påverka

Som medlem i SIS har du möjlighet att påverka framtida standarder inom ditt område på nationell, europeisk och global nivå. Du får samtidigt tillgång till tidig information om utvecklingen inom din bransch.

## Ta del av det färdiga arbetet

Vi erbjuder våra kunder allt som rör standarder och deras tillämpning. Hos oss kan du köpa alla publikationer du behöver – allt från enskilda standarder, tekniska rapporter och standardpaket till handböcker och onlinetjänster. Genom vår webbtjänst e-nav får du tillgång till ett lättnavigerat bibliotek där alla standarder som är aktuella för ditt företag finns tillgängliga. Standarder och handböcker är källor till kunskap. Vi säljer dem.

## Utveckla din kompetens och lyckas bättre i ditt arbete

Hos SIS kan du gå öppna eller företagsinterna utbildningar kring innehåll och tillämpning av standarder. Genom vår närhet till den internationella utvecklingen och ISO får du rätt kunskap i rätt tid, direkt från källan. Med vår kunskap om standarders möjligheter hjälper vi våra kunder att skapa verklig nytta och lönsamhet i sina verksamheter.

**Vill du veta mer om SIS eller hur standarder kan effektivisera din verksamhet är du välkommen in på [www.sis.se](http://www.sis.se) eller ta kontakt med oss på tel 08-555 523 00.**



# Standards make the world go round

*SIS (Swedish Standards Institute) is an independent non-profit organisation with members from both the private and public sectors. We are part of the European and global network that draws up international standards. Standards consist of documented knowledge developed by prominent actors within the industry, business world and society. They promote cross-border trade, they help to make processes and products safer and they streamline your organisation.*

## Take part and have influence

As a member of SIS you will have the possibility to participate in standardization activities on national, European and global level. The membership in SIS will give you the opportunity to influence future standards and gain access to early stage information about developments within your field.

## Get to know the finished work

We offer our customers everything in connection with standards and their application. You can purchase all the publications you need from us - everything from individual standards, technical reports and standard packages through to manuals and online services. Our web service e-nav gives you access to an easy-to-navigate library where all standards that are relevant to your company are available. Standards and manuals are sources of knowledge. We sell them.

## Increase understanding and improve perception

With SIS you can undergo either shared or in-house training in the content and application of standards. Thanks to our proximity to international development and ISO you receive the right knowledge at the right time, direct from the source. With our knowledge about the potential of standards, we assist our customers in creating tangible benefit and profitability in their organisations.

**If you want to know more about SIS, or how standards can streamline your organisation, please visit [www.sis.se](http://www.sis.se) or contact us on phone +46 (0)8-555 523 00**



Europastandarden EN 16276:2013 gäller som svensk standard. Detta dokument innehåller den officiella engelska versionen av EN 16276:2013.

The European Standard EN 16276:2013 has the status of a Swedish Standard. This document contains the official version of EN 16276:2013.

© Copyright/Upphovsrätten till denna produkt tillhör SIS, Swedish Standards Institute, Stockholm, Sverige. Användningen av denna produkt regleras av slutanvändarlicensen som återfinns i denna produkt, se standardens sista sidor.

© Copyright SIS, Swedish Standards Institute, Stockholm, Sweden. All rights reserved. The use of this product is governed by the end-user licence for this product. You will find the licence in the end of this document.

*Uppllysningar om sakinnehållet i standarden lämnas av SIS, Swedish Standards Institute, telefon 08-555 520 00. Standarder kan beställas hos SIS Förlag AB som även lämnar allmänna upplysningar om svensk och utländsk standard.*

*Information about the content of the standard is available from the Swedish Standards Institute (SIS), telephone +46 8 555 520 00. Standards may be ordered from SIS Förlag AB, who can also provide general information about Swedish and foreign standards.*

Denna standard är framtagen av kommittén för Belysning, SIS/TK 380/AG 3.

Har du synpunkter på innehållet i den här standarden, vill du delta i ett kommande revideringsarbete eller vara med och ta fram andra standarder inom området? Gå in på [www.sis.se](http://www.sis.se) - där hittar du mer information.



EUROPEAN STANDARD

**EN 16276**

NORME EUROPÉENNE

EUROPÄISCHE NORM

January 2013

---

ICS 93.080.40

English Version

## Evacuation Lighting in Road Tunnels

Éclairage des itinéraires d'évacuation dans les tunnels  
routiers

Evakuierungsbeleuchtung in Straßentunneln

This European Standard was approved by CEN on 1 December 2012.

CEN members are bound to comply with the CEN/CENELEC Internal Regulations which stipulate the conditions for giving this European Standard the status of a national standard without any alteration. Up-to-date lists and bibliographical references concerning such national standards may be obtained on application to the CEN-CENELEC Management Centre or to any CEN member.

This European Standard exists in three official versions (English, French, German). A version in any other language made by translation under the responsibility of a CEN member into its own language and notified to the CEN-CENELEC Management Centre has the same status as the official versions.

CEN members are the national standards bodies of Austria, Belgium, Bulgaria, Croatia, Cyprus, Czech Republic, Denmark, Estonia, Finland, Former Yugoslav Republic of Macedonia, France, Germany, Greece, Hungary, Iceland, Ireland, Italy, Latvia, Lithuania, Luxembourg, Malta, Netherlands, Norway, Poland, Portugal, Romania, Slovakia, Slovenia, Spain, Sweden, Switzerland, Turkey and United Kingdom.



EUROPEAN COMMITTEE FOR STANDARDIZATION  
COMITÉ EUROPÉEN DE NORMALISATION  
EUROPÄISCHES KOMITEE FÜR NORMUNG

**Management Centre: Avenue Marnix 17, B-1000 Brussels**

---

<b>Contents</b>		Page
Foreword.....		3
Introduction .....		4
1 Scope.....		5
2 Normative references.....		5
3 Terms and definitions .....		5
3.1 Tunnel construction aspects .....		5
3.2 Road tunnel evacuation lighting terms .....		7
4 Lighting of specific areas under emergency circumstances .....		8
4.1 General .....		8
4.2 Driving task lighting.....		8
4.2.1 Carriageway.....		8
4.2.2 Vehicular cross connections .....		9
4.3 Pedestrian guidance .....		9
4.3.1 General .....		9
4.3.2 Evacuation route within the main tunnel .....		9
4.3.3 Emergency exits.....		10
4.3.4 Evacuation route outside the main tunnel .....		11
Annex A (informative) A–deviations.....		13
Bibliography.....		14

## **Foreword**

This document (EN 16276:2013) has been prepared by Technical Committee CEN/TC 169 “Light and lighting”, the secretariat of which is held by DIN.

This European Standard shall be given the status of a national standard, either by publication of an identical text or by endorsement, at the latest by July 2013, and conflicting national standards shall be withdrawn at the latest by July 2013.

Attention is drawn to the possibility that some of the elements of this document may be the subject of patent rights. CEN [and/or CENELEC] shall not be held responsible for identifying any or all such patent rights.

According to the CEN/CENELEC Internal Regulations, the national standards organisations of the following countries are bound to implement this European Standard: Austria, Belgium, Bulgaria, Croatia, Cyprus, Czech Republic, Denmark, Estonia, Finland, Former Yugoslav Republic of Macedonia, France, Germany, Greece, Hungary, Iceland, Ireland, Italy, Latvia, Lithuania, Luxembourg, Malta, Netherlands, Norway, Poland, Portugal, Romania, Slovakia, Slovenia, Spain, Sweden, Switzerland, Turkey and the United Kingdom.

## **Introduction**

The Directive 2004/54/EC of the European Parliament of 29 April 2004 aims at ensuring a minimum level of safety for road users in tunnels in the Trans-European Network by the prevention of critical events that may endanger human life. With regard to lighting, there are two main cases: normal lighting and safety lighting.

Normal lighting is provided to ensure appropriate visibility during the day and night for drivers in the entrance zone as well as in the interior zone.

Safety lighting is divided into two parts: standby lighting and evacuation lighting.

Standby lighting is provided to ensure a minimum visibility for tunnel users to evacuate the tunnel in their vehicles in the event of a breakdown of the power supply.

Evacuation lighting is provided to guide tunnel users during evacuation of the tunnel on foot in emergency circumstances such as fire. Evacuation lighting includes evacuation route marker lights, emergency exit lighting, emergency exit marker lights and evacuation route lighting.



## 1 Scope

This European Standard specifies evacuation lighting in road tunnels longer than 500 m and with an AADT (Annual Average Daily Traffic) higher than 500 vehicles to facilitate the safe evacuation of vehicle occupants in evacuation situations such as fire. It addresses the fundamental issues of evacuation lighting for evacuation routes, emergency exits and cross connections, as well as giving some practical advice regarding aspects of installation and maintenance in road tunnels. It is intended to be used in conjunction with CEN/CR 14380:2003 or relevant national standards for road tunnel lighting.

The recommendations may be applied to tunnels up to 500 m in length, especially where conditions such as high traffic volume, or severe curvature or gradient apply.

It specifies lighting levels and general provisions for evacuation lighting installations that, based on experience, are considered to be necessary for the safety of people driving through road tunnels in case of an incident and particularly in case of fire. However, as there are different types of road tunnels, both in construction and traffic conditions, various types of incident may occur. This standard should be considered as a list of minimum prescriptions for evacuation lighting in tunnels, to be completed by means of specific risk analysis for the particular tunnel.

The design of marking and safety signs is not part of this standard.

## 2 Normative references

The following documents, in whole or in part, are normatively referenced in this document and are indispensable for its application. For dated references, only the edition cited applies. For undated references, the latest edition of the referenced document (including any amendments) applies.

EN 1838:1999, *Lighting applications — Emergency lighting*

EN 12665:2011, *Light and lighting — Basic terms and criteria for specifying lighting requirements*

EN 50172:2004, *Emergency escape lighting systems*

CEN/CR 14380:2003, *Lighting applications — Tunnel Lighting*

## 3 Terms and definitions

For the purposes of this document, the terms and definitions given in EN 12665:2011, EN 1838:1999 and the following apply.

### 3.1 Tunnel construction aspects

#### 3.1.1

##### **main tunnel**

part of a tunnel which contains the carriageway

#### 3.1.2

##### **carriageway**

part of the road used by vehicular traffic, normally divided into lanes

#### 3.1.3

##### **vehicular cross connections (between tunnel tubes)**

vehicular carriageway connecting adjacent tubes

SS-EN 16276:2013 (E)

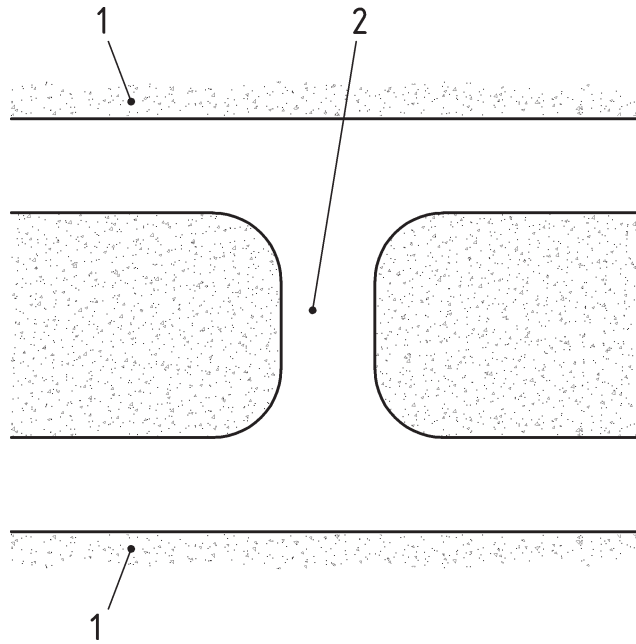

**Key**

- 1 main tunnel
- 2 vehicular cross connection

**Figure 1 — Vehicular cross connection**

**3.1.4 pedestrian cross connections (between tunnel tubes)**  
pedestrian route connecting adjacent tubes

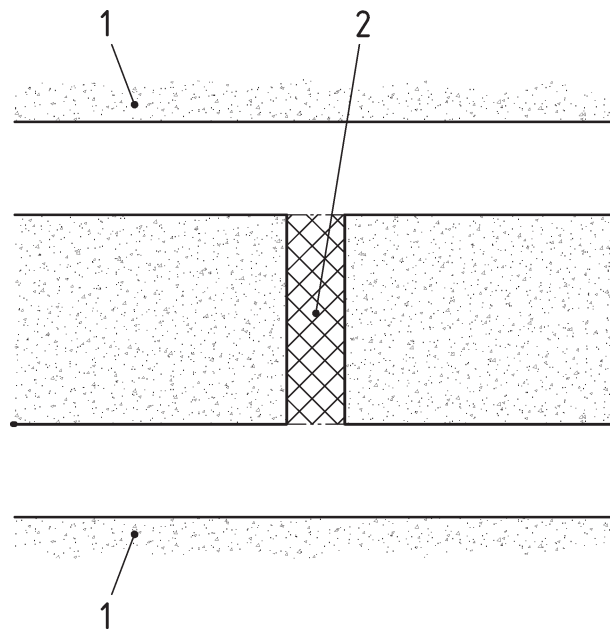

**Key**

- 1 main tunnel
- 2 pedestrian cross connection

**Figure 2 — Pedestrian cross connection**

**3.1.5**

**evacuation route within the main tunnel**

pedestrian route from a stationary vehicle to an emergency exit

**3.1.6**

**emergency exit**

exit intended to be used by pedestrians to escape from the main tunnel to a safe area (directly or via an evacuation route)

**3.1.7**

**evacuation route outside the main tunnel**

pedestrian route after an emergency exit

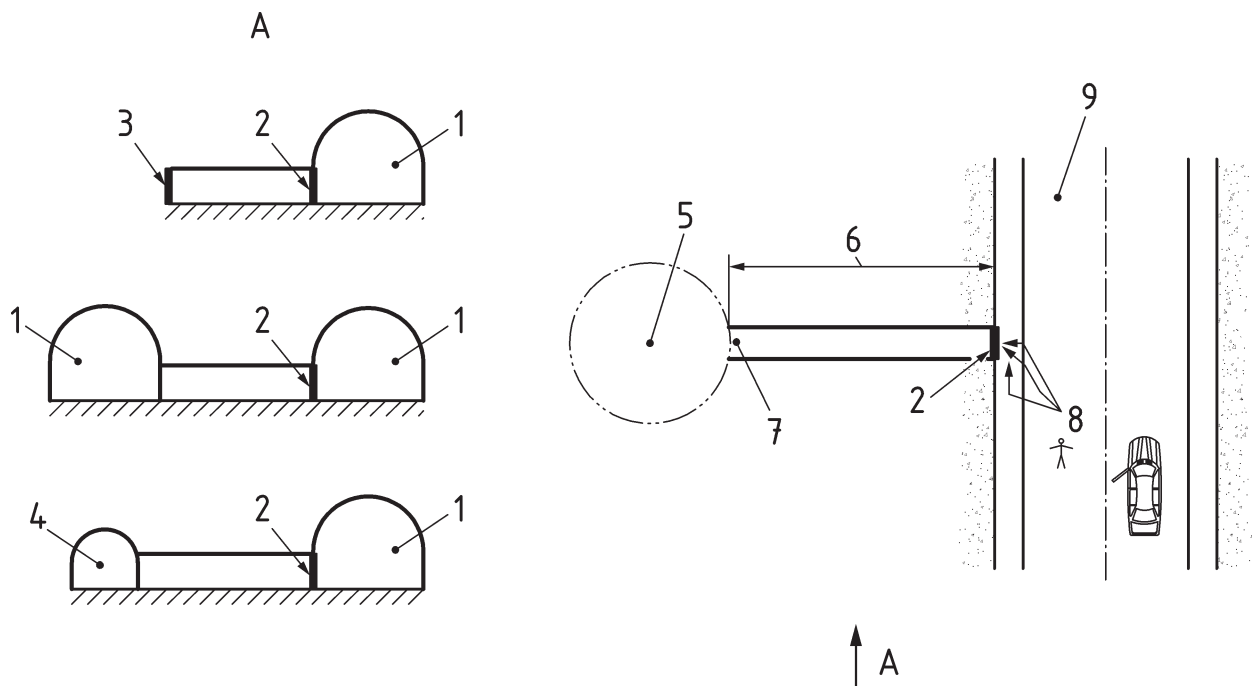

**Key**

- 1 main tunnel
- 2 emergency exit
- 3 outdoor
- 4 safety gallery
- 5 safe area
- 6 evacuation route outside the main tunnel
- 7 final exit
- 8 evacuation route within the main tunnel
- 9 carriageway

**Figure 3 — Tunnel construction examples**

**3.2 Road tunnel evacuation lighting terms**

**3.2.1**

**standby lighting**

part of the normal lighting that maintains the tunnel lighting at a specific level in the event of a breakdown of the power supply

Note 1 to entry: Standby lighting is called emergency lighting in CEN/CR 14380:2003.