



SIS - Standardiseringskommissionen i Sverige

Handläggande organ

SMS, SVERIGES MEKANSTANDARDISERING

SVENSK STANDARD SS-ISO 7803

Fastställt	Utgåva	Sida	Registrering
1989-12-06	1	1 (3)	SMS reg 466.422

SIS FASTSTÄLLER OCH UTGER SVENSK STANDARD SAMT SÄLJER NATIONELLA OCH INTERNATIONELLA STANDARDPUBLIKATIONER ©

Vägfordon — Kulleder för styrinrättning för lastbilar — Mått

Denna standard utgörs av den engelska versionen av den internationella standarden ISO 7803:1987.

Vid den internationella remissbehandlingen godkände Sverige av tekniska skäl inte standardförslaget ISO/DIS 7803. De anmärkningar som framförts av Sverige har dock i huvudsak beaktats i den slutliga versionen.

Commercial road vehicles — Steering ball joints

This Swedish standard consists of the English version of the International Standard ISO 7803:1987.

In the international voting procedure, Sweden disapproved the Draft International Standard ISO/DIS 7803 for technical reasons. However, the most important remarks submitted by Sweden have been considered in the final version.

UDK 629.11.014.52:629.114.4

Standarder kan beställas hos SIS som även lämnar allmänna upplysningar om svensk och utländsk standard.
Postadress: SIS, Box 3295, 103 66 STOCKHOLM
Telefon: 08 - 613 52 00. Telefax: 08 - 11 70 35

Upplysningar om **sakinnehållet** i standarden lämnas av SMS.
Telefon: 08 - 783 80 00. Telefax: 08 - 667 85 42

Prisgrupp F

Tryckt i februari 1990

Commercial road vehicles – Steering ball joints

1 Scope and field of application

This International Standard specifies the main dimensions of steering ball joints for commercial vehicles.

The ball joint is considered as being a single piece with its socket. Thus this International Standard covers the ball-socket assembly.

2 Dimensions

For dimensions, see the figure and table.

3 Designation

Example for the designation of a ball joint of nominal size $S\phi D = 30$ mm, where the angles $\alpha = 40^\circ$ and $\beta = 20^\circ$:

Ball joint ISO 7803 - 30 - 40 × 20

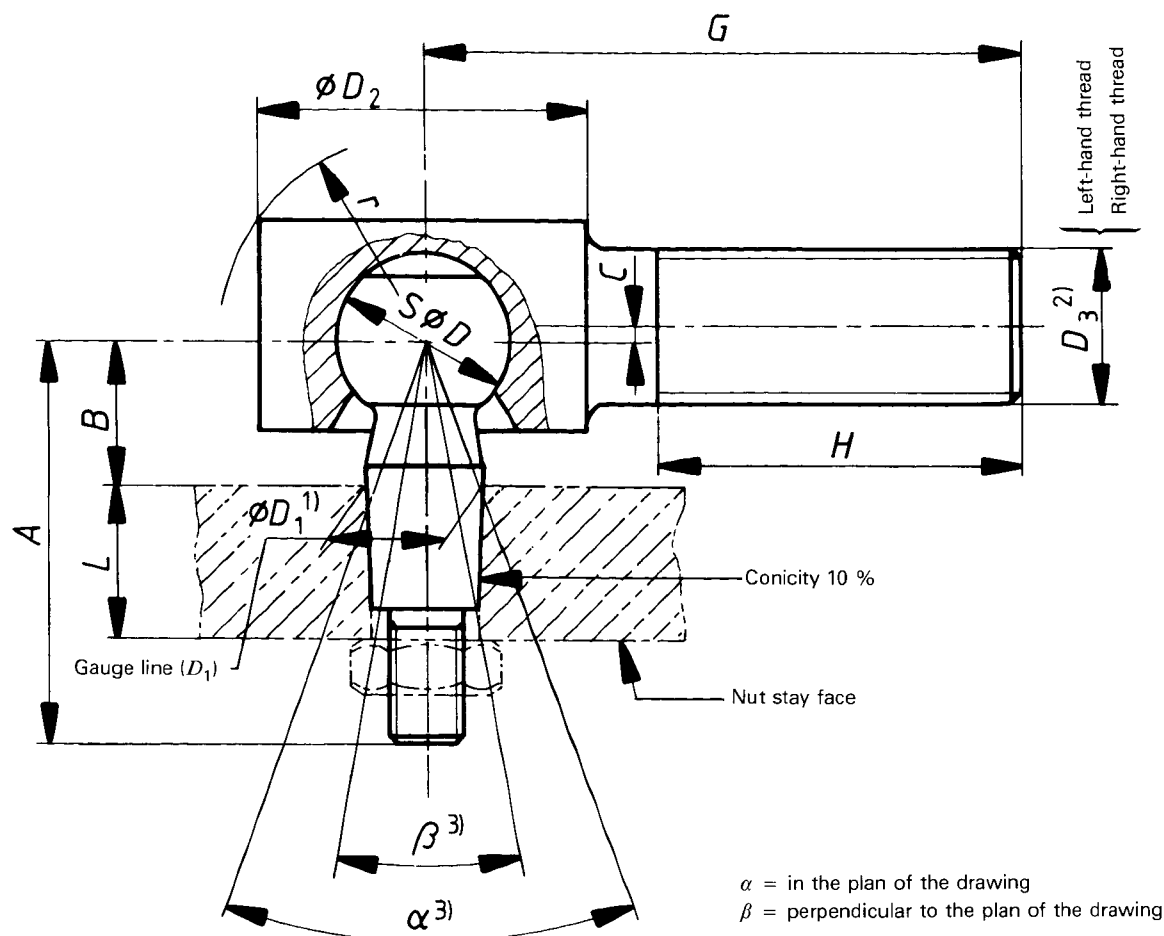

Dimensions in millimetres

Nominal size $S\phi D$	A max.	B	C max.	$D_1^{1)}$ h9*	D_2 max.	$D_3^{2)}$	G ± 2	H min.	L h11	r max.	$\alpha^{3)}$ min.	$\beta^{3)}$ min.
27	66	24	3	20	50	M24 × 1,5	95	60	24	32	40°	20°
30	71	26	3	22	58	M28 × 1,5	105	65	26	37		
35	81	30	3	26	67	M30 × 1,5	115	75	30	42		
40	91	34	3	30	74	M30 × 1,5	120	80	34	47		
50	109	40	3	38	85	M38 × 1,5	135	85	42	54		

* Bore H8.

- 1) To ensure satisfactory operation of the taper drive, it is necessary for the manufacturers to provide such tolerances that the contact between the male and female cones starts from the major diameter and extends to at least 60 % of the contact area.
- 2) The stud D_3 is available with either right-hand thread or left-hand thread. For ball joints with left-hand thread, the designation should be supplemented by the letters LH.
- 3) The vehicle manufacturer — on consultation with the ball joint manufacturer — may specify different angles.