

SVENSK STANDARD

SS-EN ISO 4172



Fastställt/Approved: 1997-01-17

Publicerad/Published: 1997-01-17

Utgåva/Edition: 1

Språk/Language: engelska/English

ICS: 01.100.30; 92.100.20

Byggritningar – Ritningar för sammanställning och montering av förtillverkade byggnadskonstruktioner (ISO 4172:1991)

Technical drawings – Construction drawings – Drawings for the assembly of prefabricated structures (ISO 4172:1991)

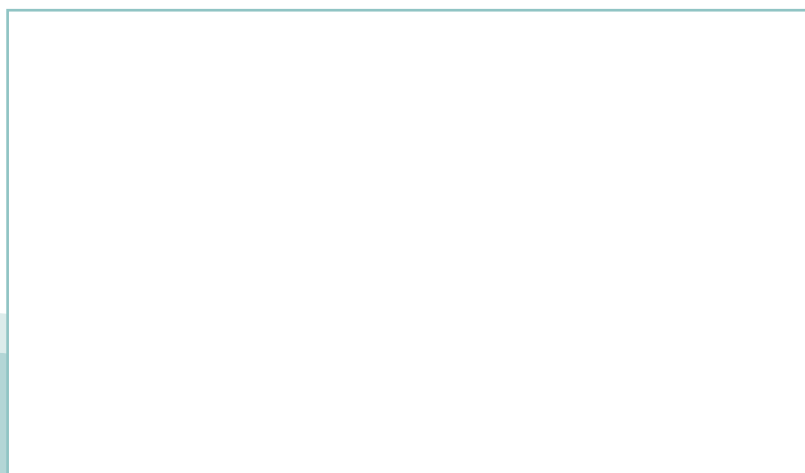

Standarder får världen att fungera

SIS (Swedish Standards Institute) är en fristående ideell förening med medlemmar från både privat och offentlig sektor. Vi är en del av det europeiska och globala nätverk som utarbetar internationella standarder. Standarder är dokumenterad kunskap utvecklad av framstående aktörer inom industri, näringsliv och samhälle och befrämjar handel över gränser, bidrar till att processer och produkter blir säkrare samt effektiviserar din verksamhet.

Delta och påverka

Som medlem i SIS har du möjlighet att påverka framtida standarder inom ditt område på nationell, europeisk och global nivå. Du får samtidigt tillgång till tidig information om utvecklingen inom din bransch.

Ta del av det färdiga arbetet

Vi erbjuder våra kunder allt som rör standarder och deras tillämpning. Hos oss kan du köpa alla publikationer du behöver – allt från enskilda standarder, tekniska rapporter och standardpaket till handböcker och onlinetjänster. Genom vår webbtjänst e-nav får du tillgång till ett lättnavigerat bibliotek där alla standarder som är aktuella för ditt företag finns tillgängliga. Standarder och handböcker är källor till kunskap. Vi säljer dem.

Utveckla din kompetens och lyckas bättre i ditt arbete

Hos SIS kan du gå öppna eller företagsinterna utbildningar kring innehåll och tillämpning av standarder. Genom vår närhet till den internationella utvecklingen och ISO får du rätt kunskap i rätt tid, direkt från källan. Med vår kunskap om standarders möjligheter hjälper vi våra kunder att skapa verklig nytta och lönsamhet i sina verksamheter.

Vill du veta mer om SIS eller hur standarder kan effektivisera din verksamhet är du välkommen in på www.sis.se eller ta kontakt med oss på tel 08-555 523 00.

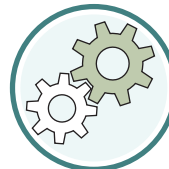

Standards make the world go round

SIS (Swedish Standards Institute) is an independent non-profit organisation with members from both the private and public sectors. We are part of the European and global network that draws up international standards. Standards consist of documented knowledge developed by prominent actors within the industry, business world and society. They promote cross-border trade, they help to make processes and products safer and they streamline your organisation.

Take part and have influence

As a member of SIS you will have the possibility to participate in standardization activities on national, European and global level. The membership in SIS will give you the opportunity to influence future standards and gain access to early stage information about developments within your field.

Get to know the finished work

We offer our customers everything in connection with standards and their application. You can purchase all the publications you need from us - everything from individual standards, technical reports and standard packages through to manuals and online services. Our web service e-nav gives you access to an easy-to-navigate library where all standards that are relevant to your company are available. Standards and manuals are sources of knowledge. We sell them.

Increase understanding and improve perception

With SIS you can undergo either shared or in-house training in the content and application of standards. Thanks to our proximity to international development and ISO you receive the right knowledge at the right time, direct from the source. With our knowledge about the potential of standards, we assist our customers in creating tangible benefit and profitability in their organisations.

If you want to know more about SIS, or how standards can streamline your organisation, please visit www.sis.se or contact us on phone +46 (0)8-555 523 00

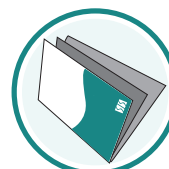

Europastandarden EN ISO 4172:1996 gäller som svensk standard. Detta dokument innehåller den officiella engelska versionen av EN ISO 4172:1996.

Denna standard ersätter SS-ISO 4172, utgåva 1.

The European Standard EN ISO 4172:1996 has the status of a Swedish Standard. This document contains the official English version of EN ISO 4172:1996.

This standard supersedes the Swedish Standard SS-ISO 4172, edition 1.

© Copyright/Upphovsrätten till denna produkt tillhör SIS, Swedish Standards Institute, Stockholm, Sverige. Användningen av denna produkt regleras av slutanvändarlicensen som återfinns i denna produkt, se standardens sista sidor.

© Copyright SIS, Swedish Standards Institute, Stockholm, Sweden. All rights reserved. The use of this product is governed by the end-user licence for this product. You will find the licence in the end of this document.

Uppllysningar om sakinnehållet i standarden lämnas av SIS, Swedish Standards Institute, telefon 08-555 520 00. Standarder kan beställas hos SIS Förlag AB som även lämnar allmänna uppllysningar om svensk och utländsk standard.

Information about the content of the standard is available from the Swedish Standards Institute (SIS), telephone +46 8 555 520 00. Standards may be ordered from SIS Förlag AB, who can also provide general information about Swedish and foreign standards.

Har du synpunkter på innehållet i den här standarden, vill du delta i ett kommande revideringsarbete eller vara med och ta fram andra standarder inom området? Gå in på www.sis.se - där hittar du mer information.

EUROPEAN STANDARD

EN ISO 4172

NORME EUROPÉENNE

EUROPÄISCHE NORM

November 1996

ICS 01.100.30

Descriptors: see ISO document

English version

**Technical drawings - Construction drawings -
Drawings for the assembly of prefabricated
structures (ISO 4172:1991)**

Dessins techniques - Dessins de construction -
Dessins d'assemblage des structures
préfabriquées (ISO 4172:1991)

Technische Zeichnungen - Zeichnungen für das
Bauwesen - Zeichnungen für den Zusammenbau
vorgefertigter Teile (ISO 4172:1991)

This European Standard was approved by CEN on 1996-10-25. CEN members are bound to comply with the CEN/CENELEC Internal Regulations which stipulate the conditions for giving this European Standard the status of a national standard without any alteration.

Up-to-date lists and bibliographical references concerning such national standards may be obtained on application to the Central Secretariat or to any CEN member.

The European Standards exist in three official versions (English, French, German). A version in any other language made by translation under the responsibility of a CEN member into its own language and notified to the Central Secretariat has the same status as the official versions.

CEN members are the national standards bodies of Austria, Belgium, Denmark, Finland, France, Germany, Greece, Iceland, Ireland, Italy, Luxembourg, Netherlands, Norway, Portugal, Spain, Sweden, Switzerland and United Kingdom.

CEN

European Committee for Standardization
Comité Européen de Normalisation
Europäisches Komitee für Normung

Central Secretariat: rue de Stassart, 36 B-1050 Brussels

Foreword

The text of the International Standard from Technical Committee ISO/TC 10 "Technical drawings, product definition and related documentation" of the International Organization for Standardization (ISO) has been taken over as an European Standard by CEN/CS.

This European Standard shall be given the status of a national standard, either by publication of an identical text or by endorsement, at the latest by May 1997, and conflicting national standards shall be withdrawn at the latest by May 1997.

According to the CEN/CENELEC Internal Regulations, the national standards organizations of the following countries are bound to implement this European Standard: Austria, Belgium, Denmark, Finland, France, Germany, Greece, Iceland, Ireland, Italy, Luxembourg, Netherlands, Norway, Portugal, Spain, Sweden, Switzerland and the United Kingdom.

Endorsement notice

The text of the International Standard ISO 4172:1991 has been approved by CEN as a European Standard without any modification.

NOTE: Normative references to International Standards are listed in annex ZA (normative)

Technical drawings — Construction drawings — Drawings for the assembly of prefabricated structures

1 Scope

This International Standard specifies general rules for the preparation of working drawings intended for the field assembly of prefabricated structures for building and civil engineering works.

2 Normative references

The following standards contain provisions which, through reference in this text, constitute provisions of this International Standard. At the time of publication, the editions indicated were valid. All standards are subject to revision, and parties to agreements based on this International Standard are encouraged to investigate the possibility of applying the most recent editions of the standards indicated below. Members of IEC and ISO maintain registers of currently valid International Standards.

ISO 128:1982, *Technical drawings — General principles of presentation*.

ISO 129:1985, *Technical drawings — Dimensioning — General principles, definitions, methods of execution and special indications*.

ISO 1046:1973, *Architectural and building drawings — Vocabulary*.

ISO 2444:1988, *Joints in building — Vocabulary*.

ISO 2445:1972, *Joints in building — Fundamental principles for design*.

ISO 2553:1984, *Welds — Symbolic representation on drawings*.

ISO 4068:1978, *Building and civil engineering drawings — Reference lines*.

ISO 4157-1:1980, *Building drawings — Part 1: Designation of buildings and parts of buildings*.

ISO 5455:1979, *Technical drawings — Scales*.

ISO 5457:1980, *Technical drawings — Sizes and layout of drawing sheets*.

ISO 6284:1985, *Tolerances for building — Indication of tolerances on building and construction drawings*.

ISO 7200:1984, *Technical drawings — Title blocks*.

ISO 7437:1990, *Technical drawings — Construction drawings — General rules for execution of production drawings for prefabricated structural components*.

ISO 8048:1984, *Technical drawings — Construction drawings — Representation of views, sections and cuts*.

3 Definitions

For the purposes of this International Standard, the following definitions apply.

3.1 prefabricated structure: Structure erected out of prefabricated structural components.

3.2 prefabricated structural component: Component of a prefabricated structure delivered to the construction site as a purpose-made part.

4 Documentation

4.1 General

The documentation for prefabricated structures shall comprise

- a) location drawings (general arrangement drawings),
- b) detail drawings,

- c) component schedules (and component range drawings), and
- d) additional specifications and lists for incidental materials, special shipping instructions, etc.

These shall be prepared in accordance with the relevant parts of the International Standards listed in clause 2.

4.2 Location drawings

4.2.1 A location drawing is a simplified representation of a prefabricated structure and the location of designated structural components. The components may be represented by an extra thick line (see figure 1, figure 3 and figure 4) or by their simplified outlines.

For each group of components for prefabricated structures, connected by similar construction conditions, the location drawings should be given in the sequence of their application during the assembly.

If necessary, design charts or loading schemes shall be given on location drawings, which shall indicate loading limitations, erection procedures, and other details concerning erection and assembly such as joints and jointing and temporary works, and shall refer to documents giving such information.

The location drawings for prefabricated structures shall show the following:

- a) layout grid lines of buildings;
- b) designations of structural components;
- c) relationship of components to the layout grid lines;
- d) specific levels of structural components;
- e) reference to the detail drawings.

The structural components should be shown in plans, sections or views, as illustrated in figures 1 to 6.

The location drawings for complicated three-dimensional structures should be made in different planes.

The preferred scales for location drawings are 1:50, 1:100 and 1:200.

4.2.2 On the location drawings of prefabricated foundations and other underground structures it is also recommended to show the following:

- a) outline of foundation beds;
- b) foundation sublayers (broken line);

- c) their sizes;
- d) their relationship to layout grids;
- e) foundation beams;
- f) basement walls.

Location drawings for foundation and other underground structures shall be represented on the assumption that the ground is transparent.

4.2.3 In the title of the location drawing for a prefabricated floor, reference should be made to the number of the floor or to the level of an intermediate floor or a stair landing, in accordance with ISO 4157-1.

4.2.4 In draughting the location drawings for prefabricated panel wall structures, the outlines of the component shall be shown with thick lines (see figure 6).

4.3 Detail drawings

4.3.1 Details may be shown on separate drawings or may be included as additional information on the location drawings.

The preferred scales for details are 1:20, 1:10 and 1:5.

Details shall be properly annotated on the relevant location drawings. Details should be given in the same sequence of the order of the respective section on the drawing.

4.3.2 Representations of joints will be the main part of the detail drawing. Joints are usually shown on separate sheets.

A representation of joints shows the relationship between prefabricated structural components, where they come together, and shall show

- a) layout grid lines,
- b) joint dimensions with an indication of the necessary tolerances,
- c) the designations of components shown on the location drawing and, if required, additional marks to identify the surfaces that are to come together at the joint,
- d) methods of connection, e.g. welding, bolted connections or the use of continuity reinforcement, in conjunction with site-poured concrete, and
- e) built-in parts and connection details, including the products to be used.

Two joints, the one being a mirror image of the other, shall be shown as two independent joints, and have independent designations.

If it is necessary to differentiate between the graphical representation of joints required for erection and assembly and those representations that describe the finishing of the joint (i.e. corrosion protection, thermal movement, etc.), or between supporting joints, sealing joints and open joints, this shall be done by using separate designations, or symbols that are explained on the drawing.

Examples of the graphical representation of joints are given in figure 7 and figure 8.

NOTE 1 Where necessary, the graphical representation of joints should be supplemented by text covering such matters as erection procedures, assembly and corrosion protection.

4.4 Component schedules

4.4.1 A component schedule is a document listing components of prefabricated structures.

4.4.2 A component schedule shall contain the following information in the sequence listed:

- a) designation of the components (unique reference);
- b) denomination of the components;
- c) number of components.

4.4.3 The component schedule should also contain the following information in the sequence listed:

- a) mass, in kilograms or tonnes;
- b) sizes;
- c) total mass, in kilograms or tonnes;
- d) special references;
- e) remarks.

If the component schedule is prepared on one or several separate sheets, each sheet shall have its own title block, placed below the schedule.

5 Designation of prefabricated structural components

On the location drawing the prefabricated components shall be denoted by designations.

Components that are identical should have identical designations.

Structural components which are located manually shall be designated with independent designations.

The designations of components on the location drawings and detail drawings shall be shown adjacent to the graphical representation of a component [see figure 9a) and figure 9b)], or with leader lines [see figure 9c)].

The designations given in figures 1 to 10 are only examples.

NOTE 2 Figures 1 to 10 relate to a single typical structure and are for illustrative purposes only.

Dimensions in millimetres

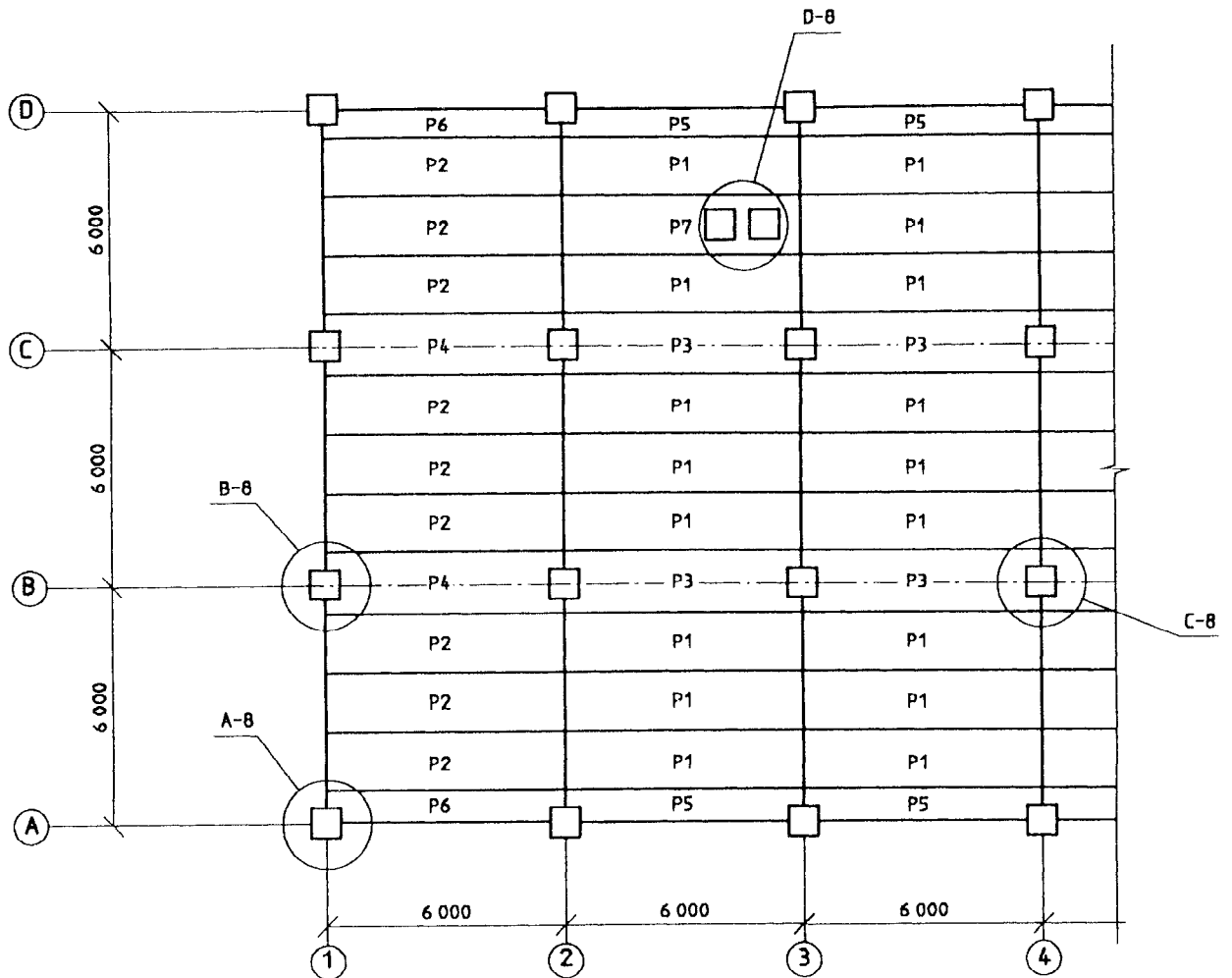

Figure 2 — An example of a location drawing (plan) for floor slabs (Scale 1:200)